

The following information in this file comes directly from Blink Blinds + Glass, the manufacturer of our mini blind panels.

Operation and Maintenance:

Blinds typically require 24-48 hours to acclimate for proper performance. This time will vary depending on geographical location, air pressure and temperature. Recent changes in any of these conditions will lengthen the acclimation time.

To ensure years of smooth, easy operation of your blinds, follow these simple instructions:

- Slide the operator up and down to position the blind to the desired height. Some blinds have a separate tilt control; slide it up or down to tilt the blinds to the desired angle.
- For ease of operation, ensure the glass surface is clean. Dirty glass can impede operator movement, thus requiring more force to operate the blinds.

Troubleshooting:

How to Re-Engage the Blinds Operator

Blinds between glass raise and lower with the use of magnets inside the glass and on the external operator. Occasionally, the operator can come loose from the internal magnets, causing the blind to not operate properly. If your operator comes loose, the operator magnets have become disengaged.

To re-engage the operator:

1. With the operator against the glass, raise the operator up at a moderate speed to the top of the unit.
2. You will hear and feel a click as the magnets begin to re-engage.
3. Continue to slide the operator upward until you hear a second click. The second click tells you the operator is now re-engaged.

NOTE: You must feel or hear two clicks to fully re-engage the magnets. (Diagrams A and B)

How to Exercise the Blinds for Proper Lowering

If the blinds between glass in your window or door have been in a raised position for a long time, the blinds might not lower properly when first lowered. "Exercising" the blinds will correct this issue. To exercise your blinds:

1. Make sure the blinds are tilted fully open.
2. Fully lower the blinds at a moderate speed and fully raise the blinds. Repeat several times until the blind functions properly.

How to Level the Blinds

Occasionally when operating blinds between glass, the blind might become out-of-level, with one side of the blind being higher than the other. To adjust your blinds back to a level position:

1. Simply raise the blinds at a moderate speed to a fully open position and then fully lower them.
2. Repeat if necessary and the blinds will adjust themselves and level.

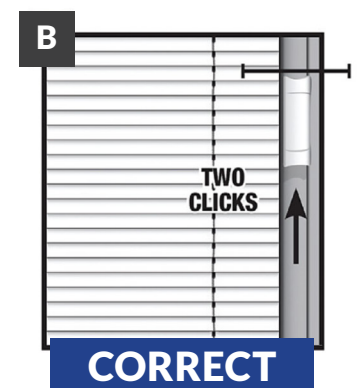
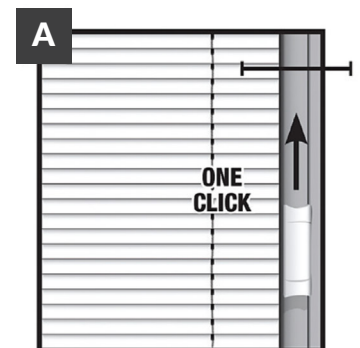

For more help, visit www.blinkblinds.com. ☰